



House Five-bedroom (6+1)

Rented

230 m², Prague 6, Dejvice, Na Čihadle





House Five-bedroom (6+1)

Rented

230 m², Prague 6, Dejvice, Na Čihadle

Plot	221 m ²
Foot print	78 m ²
Garden	143 m ²
Parking	Garage and parking on the plot.
Garage	Yes
Cellar	Yes
Service price	Utilities are billed separately.
PENB	G
Reference number	32773
Available from	Immediately

Boasting an exclusive location, this is a fully newly refurbished and partially extended 5-bedroom 2-bathroom townhouse with a front garden and parking. Situated in a quiet street in the prestigious Hanspaulka residential neighborhood, near the lovely Horní Šárka forest park. The location is comfortably accessible by public transportation, with quick access to the city center, the airport and international schools. A few minute drive to Bořislavka and Dejvická metro stations, with full amenities in the area.

The ground floor includes a living room, a fully fitted eat-in kitchen, a bathroom (bathtub, bidet, toilet), and an entrance hall with a built-in wardrobe. The first floor features a spacious central hall, two bedrooms with fitted **walk-in closets**, and a bathroom (walk-in shower, bidet, toilet). The second floor consists of two **air-conditioned** bedrooms - one with a **balcony**, a toilet, and attic storage. There is a basement floor with a guest bedroom / office with French windows leading to a patio, a toilet, and a boiler / laundry room.

Vinyl floors, tiles, gas boiler, dishwasher, microwave oven, central vacuum cleaner. **Garage and two parking spaces** in front of the garage are available.

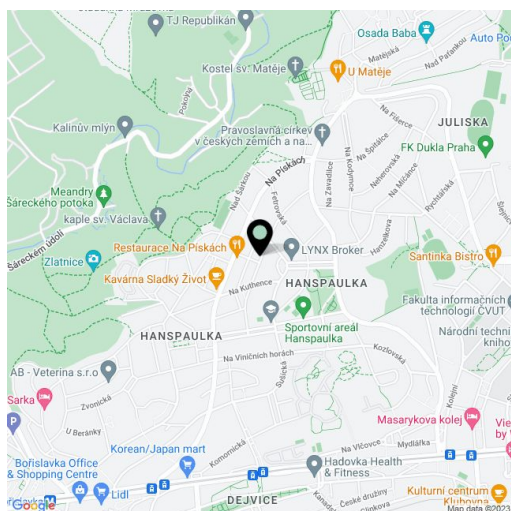



House Five-bedroom (6+1)

230 m², Prague 6, Dejvice, Na Čihadle

Rented

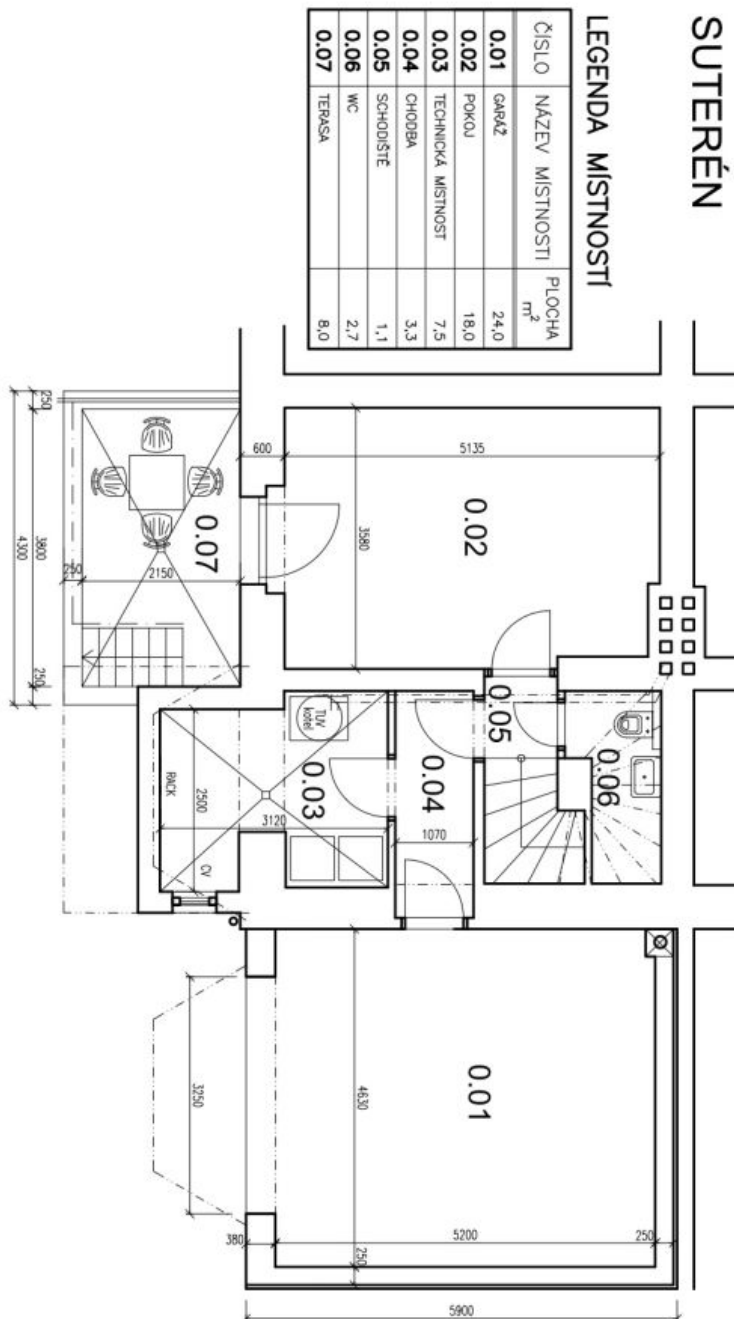



House Five-bedroom (6+1)

230 m², Prague 6, Dejvice, Na Čihadle

Rented

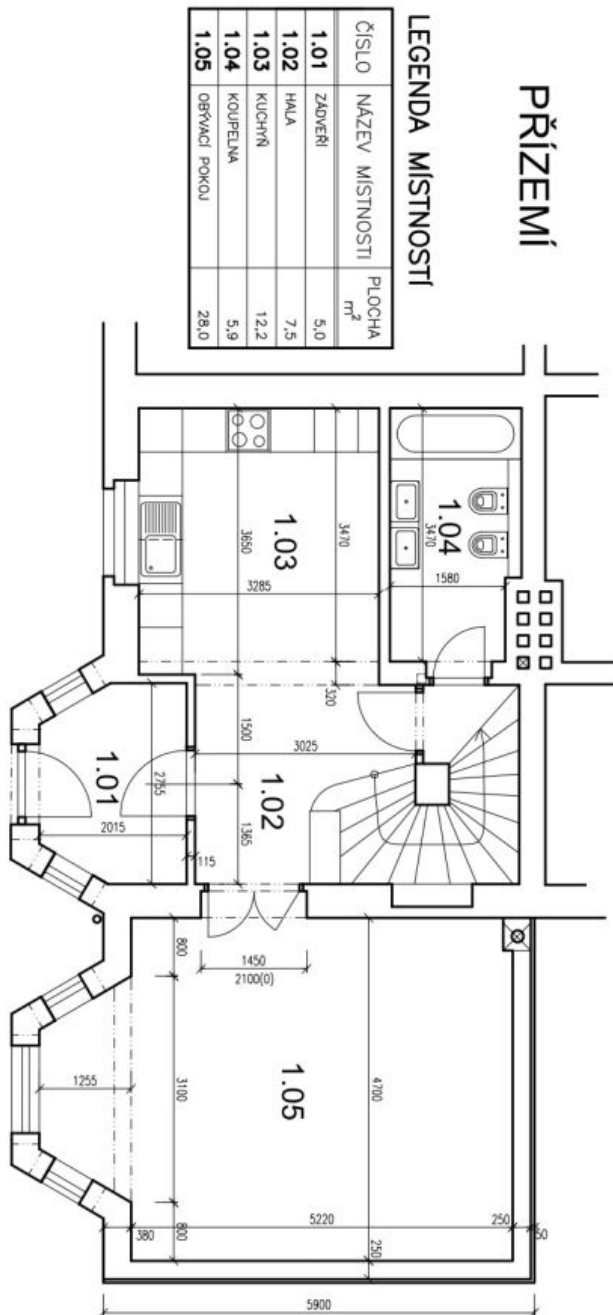



House Five-bedroom (6+1)

230 m², Prague 6, Dejvice, Na Čihadle

Rented

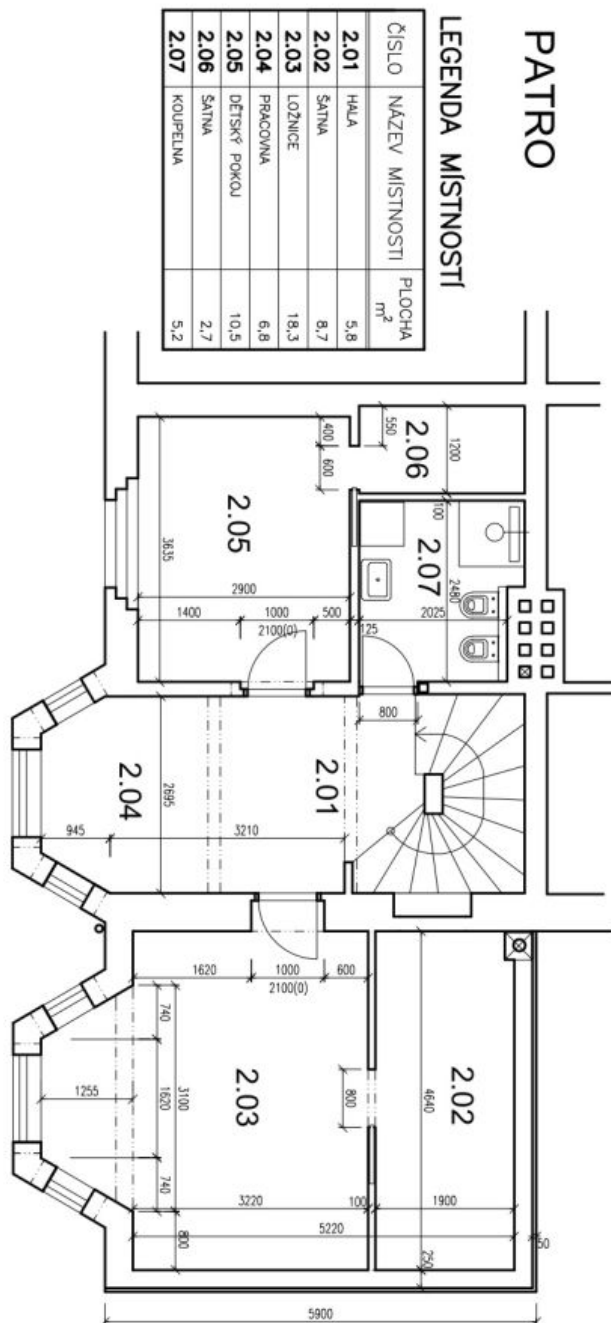



House Five-bedroom (6+1)

230 m², Prague 6, Dejvice, Na Čihadle

Rented

